

SITE-SPECIFIC SAFETY PLAN TEMPLATE

Date: March 2014

This Site-Specific Safety Plan Template contains general information that is typically part of a complete Site-Specific Safety Plan that may be required under applicable Federal and State regulations when conducting soil excavation at the Del Oeste Veterinary Clinic property or along the adjacent Prairie Road. All information contained in this Template should be verified for correctness before inclusion into a complete Site-Specific Safety Plan.

Table 1. Contacts		
Project Manager		
Project Number		
Site/Project Name	Del Oeste Veterinary Clinic	
Site Address/Location	90238 Prairie Road, Eugene, Oregon	
Site Contact		
Name	Richard Mosier	
Phone	541-689-0205	
Emergency Contacts		
Contact	Name	Phone Number
Local Police	Eugene Police Department	911
Local Ambulance		911
Local Fire Department	Eugene Fire Department	911
Local Hospital	Peace Health Sacred Heart Medical Center	(541) 686-7300
Local Hospital Address	RiverBend Campus 3333 RiverBend Drive Springfield, OR 97477	
Poison Control Center	Oregon Poison Center	1-800-222-1222
Local Contractor's Office		

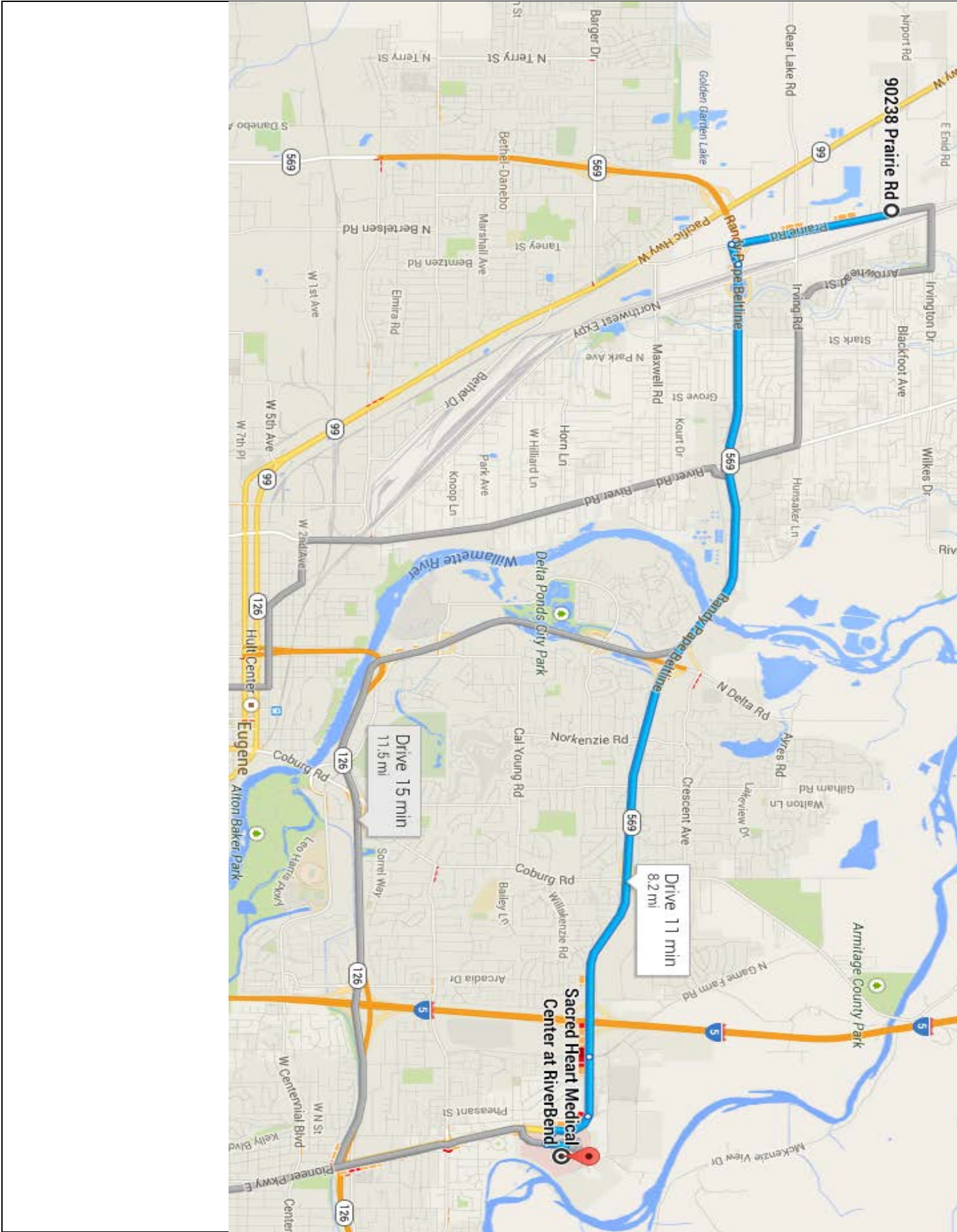

Table 2. Locations of Nearest . . . (locate on map)

Telephone	Cell phone
Running Water Source	Del Oeste office
Public Road	Prairie Road
Rest Room	

Table 3. Site Activities Planned



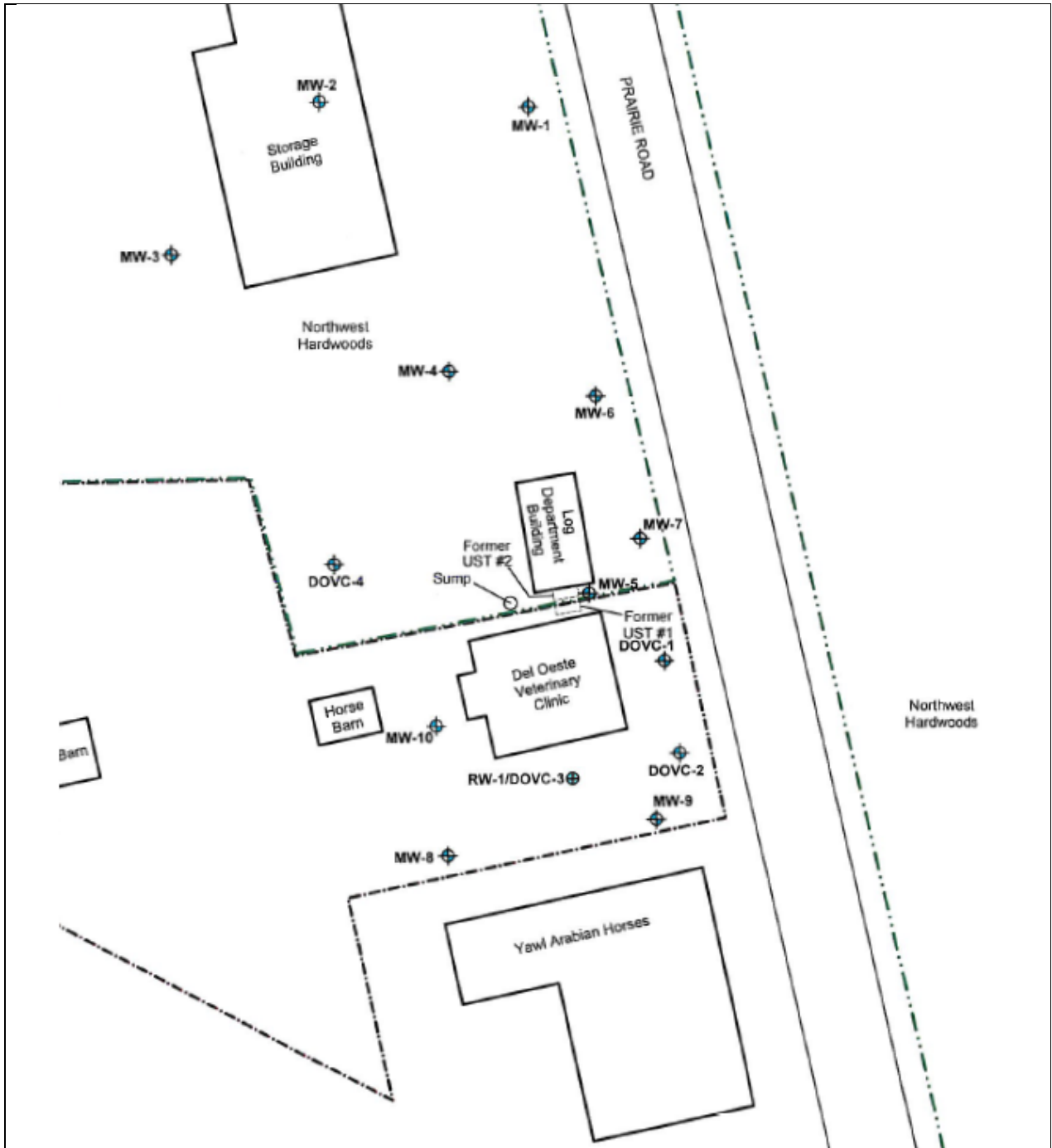

Activity	Location	Date

Table 4. Site Status

Active	X
Inactive	
Abandoned	
Unknown	



LEGEND

-  Northwest Hardwoods Property Boundary
-  Del Oeste Property Boundary
-  Monitoring Well Location
-  Product Recovery/Monitoring Well Location

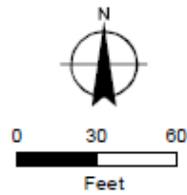

Site Map
 Del Oeste Vet Clinic
 Prairie Road
 Eugene, Oregon

Table 5. Hazard Assessment	
Hazard of Concern	
Heat Stress	
Cold Stress	
Explosive/Flammable	
Oxygen Deficient	
Excessive Noise	
Inorganic Chemicals	
Organic Chemicals	Petroleum products
Other	
Chemical State	
Liquid	
Solid	
Gas	
Other	
Unknown	
Chemical Characteristics	
Corrosive	
Flammable	X
Toxic	X
Volatile	X
Inert	
Other	

Describe Potential Site Hazards.

Soils and groundwater containing aged gasoline and diesel fuels may be encountered when excavating soil at the property and along Prairie Road adjacent to the property.

Table 6. Safety Considerations	
Monitoring Equipment	
Organic Vapor Meter	
O ₂ Meter	
Explosimeter	
H ₂ S Meter	
Other	
Actions to Take if Hazards Listed in Table 5 (Hazard Assessment) Occur	
<p>A project specific safety plan should be prepared to address specific risks associated with work that includes soil excavating at the property and along Prairie Road adjacent to the property.</p>	

Table 7. Activity Considerations	
Will Site Representative be Present?	
Yes	
No	
Exact location of Chemicals	
Known	X
Assumed	X
Unknown	X
Characterize Nearest Offsite Population	
Residential	X
Industrial	X
Rural	
Urban	

Table 8. Personal Protective Equipment (PPE) to be Used		
Foot	Petroleum resistant, as needed	
Hand	Petroleum resistant, as needed	
Eye/Face		
Head		
Ear		
Clothing	Long sleeve shirt and pants	
Respiratory		
Additional Gear		
Other	Project specific PPE should be addressed in a project specific safety plan	
First Aid Kit		
Yes		
No		
Training Requirements		
Type of Certificate	Yes	No
• HAZWOPER 40-Hour	X	
• HAZWOPER 8-Hour Refresher	X	
• First Aid/CPR/AED	As required by employer	

Table 9. Work Party		
Name	Responsibility	Level of Protection
Site Entry Procedures		
Criteria for Changing Protection		
Work Limitations (time of day, conditions, etc.)		
Disposal of Regulated Materials, Drill Spoils, Decon Water		
See Contaminated Media Management Plan for DEQ UST Site #20-97-7034, Del Oeste Veterinary Clinic, 90238 Prairie Road, Eugene, Oregon, dated March 2014		

Table 10. Signatures for Site-Specific Safety Plan		
	Signature	Date
Prepared by		
Reviewed by		
Project Manager		